

CNC 數控精工

CNC Precision Machining

T6 鍛造泵體

T6 Forged Pump Body

直推式煞車

Direct-push braking



MASTER PUMP SERIES

摩法斯總泵系列

分離式/一體式

Split-type / Integrated

摩法斯總泵系列

Split Master Cylinder

分離式鍛造總泵

INTEGRAL FORGED UPPER PUMP



泵體與油杯分體設計，適配不同容量油杯，滿足多樣車型改裝佈局，預留充足個性化空間，精密加工鋁合金泵體，強度與耐用性兼顧，從容應對日常騎行與激烈操控，密封油杯精準控壓，杜絕漏油，保障剎車穩定；拉桿符合人體工學，握持舒適，反饋清晰；調節旋鈕操作簡便，可按握距與發力習慣靈活調校；不鏽鋼固件抗腐防鏽，延長使用壽命。

Split pump and reservoir design fits various oil capacities, adapting to diverse vehicle modifications with ample customization space. Precision-machined aluminum pump balances strength and durability, handling daily use and intense riding effortlessly. Sealed reservoir controls pressure to prevent leaks, ensuring stable braking. Ergonomic lever for comfort and clear feedback. Easy-adjust knob tunes to grip and force habits. Stainless steel hardware resists corrosion, extending lifespan. The lever features ergonomic design for comfortable grip, no fatigue even with long use, and clear operational feedback. The adjustment knob is user-friendly, allowing flexible tuning based on grip distance and force habits. Stainless steel hardware enhances corrosion resistance, extending component lifespan.

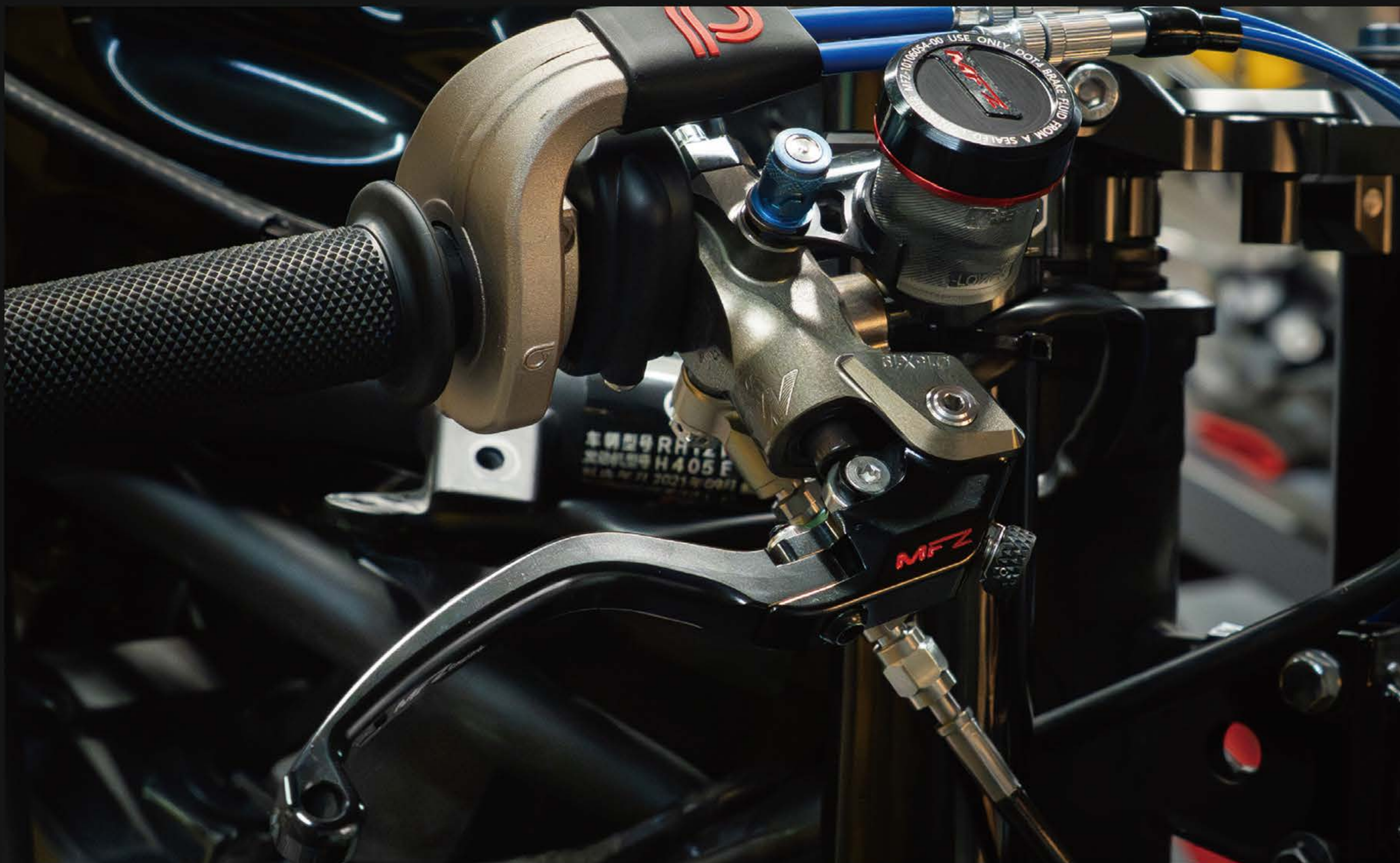

電子開關設計

Microswitch design



分離式油杯

Lightweight design



T6鍛造鋁合金

T6 Forged Aluminum Alloy



摩法斯總泵系列

Split Master Cylinder

● 鋁合金鍛造工藝解析 / Analysis of Aluminum Alloy Forging Process

根據車型和剎車系統的不同，總泵也有多種規格和型號可供選擇，以滿足不同車輛需求，改裝總泵可以帶來更加懸性和靈敏的剎車手感，以及更好的剎車力度把控。

Master cylinders are available in various specifications and models to suit different vehicle types and brake systems, ensuring they meet the needs of diverse vehicles. Upgrading the master cylinder can deliver a more linear and responsive braking feel, along with better control over braking force.



● 左 MCS



● 右 MAS



泵體鋁合金鍛造加工過程

Forging process of aluminum alloy pump body

經3D設計與虛擬驗證,以高強度鋁合金鍛造、CNC加工成型,多輪檢驗及表面處理,全程資料管控,確保性能穩定、適配精準。

3D designed, virtually verified; high-strength aluminum alloy forged, CNC machined; multi-checked, surface-treated; full-process data-controlled for stable performance, precise fit.

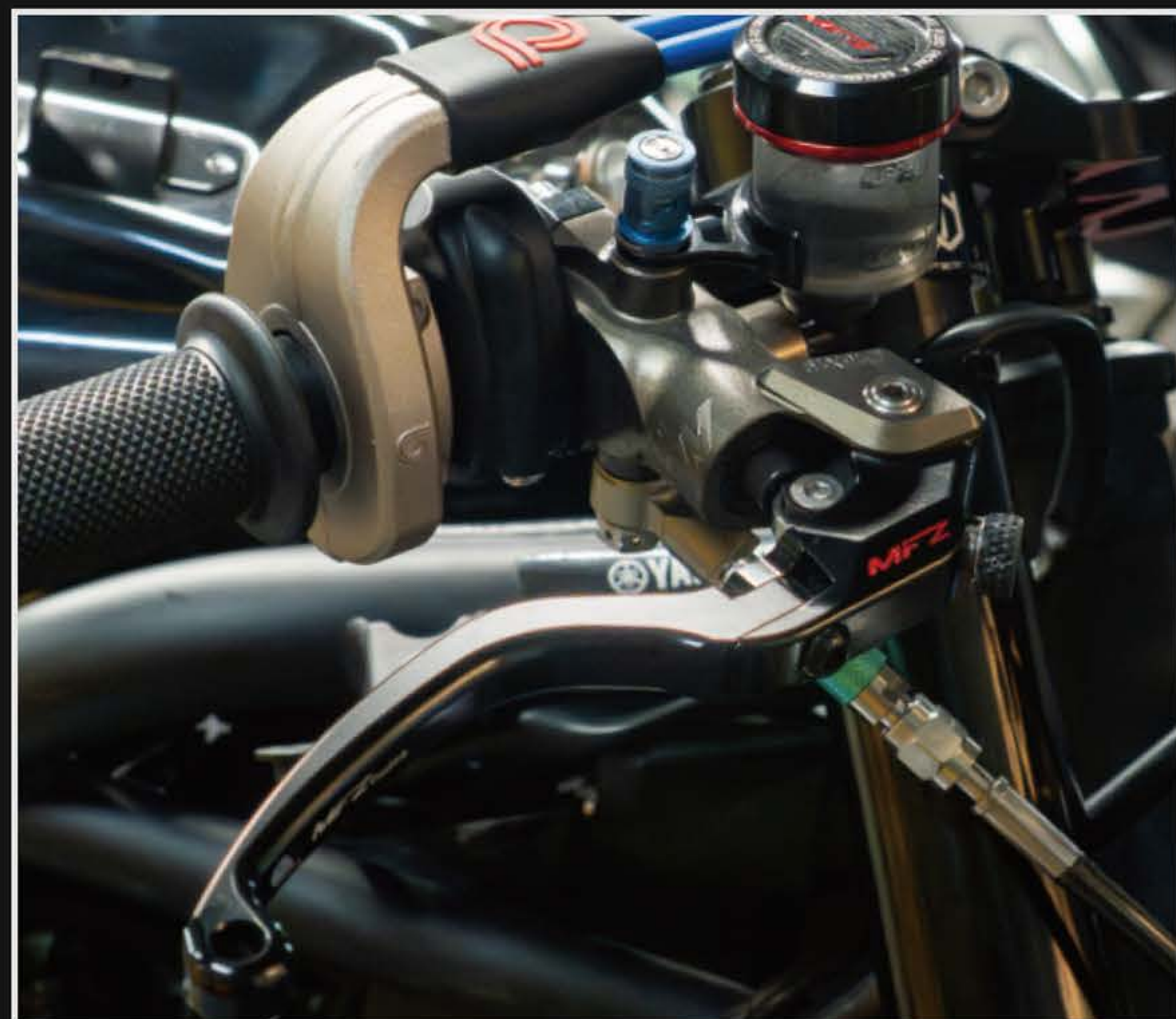

不鏽鋼定位調節軸

Stainless steel positioning adjustment shaft

精密加工保障總泵與煞車系統連動穩定,長期使用保剛性、防形變偏差。

Stable master cylinder-brake linkage, retains rigidity and resists deformation over time.



CNC總泵後壓板

CNC master cylinder rear pressure plate

CNC 後壓板透過精確的加工尺寸,能夠讓總泵穩定地處於理想位置,保證煞車系統正常發揮作用。

CNC rear pressure plate, with precise machining, keeps the master cylinder stable in optimal position, ensuring proper brake system operation.



二種後壓板可選 (僅支持01/05款)

Two types available (only compatible with models 01/05)



常規款
Regular version



後視鏡款
Rearview mirror version

輪轂
Wheel

卡鉗
Calipers

上泵
Master Pump

減震
Shock absorption

配件
Attachment

摩法斯總泵系列

Split Master Cylinder

● 減化油泵檢修 / Simplified oil pump maintenance

透過快速釋放支架簡易操作機制,可在無需複雜工具的情況下快速完成油泵與車身的分離或固定,可適配不同型號油泵或滿足特定車型的安裝空間需求

The quick-release bracket's simple mechanism enables fast separation or fixing of the oil pump from the vehicle body without complex tools, compatible with various oil pump models and meeting specific vehicle installation space needs.

● 快速釋放支架/Quick-Release Bracket

在日常保養換油、油泵檢修時,無需拆卸多個螺栓,僅需解鎖支架即可取下油泵,大幅縮短維護時間,尤其適合戶外應急維修或高頻保養場景。

During routine oil changes or pump checks, no need to remove multiple bolts—just unlock the bracket to take off the oil pump. This cuts maintenance time significantly, ideal for outdoor emergency repairs or frequent maintenance.



油杯固定片

Oil Reservoir Fixing Plate



C型環支架

C-Type Ring Bracket

● 創新技術提升騎行體驗 / Innovative technology enhances riding experience

● 輕量革命,設計先行

Lightweight Revolution, Design First.

過程透過全三維加工鍛造毛坯,追求輕量化、緊湊化和高剛性

The cutting process, through the full three-dimensional machining forging blank, the pursuit of lightweight and compact Chemical and high rigidity.

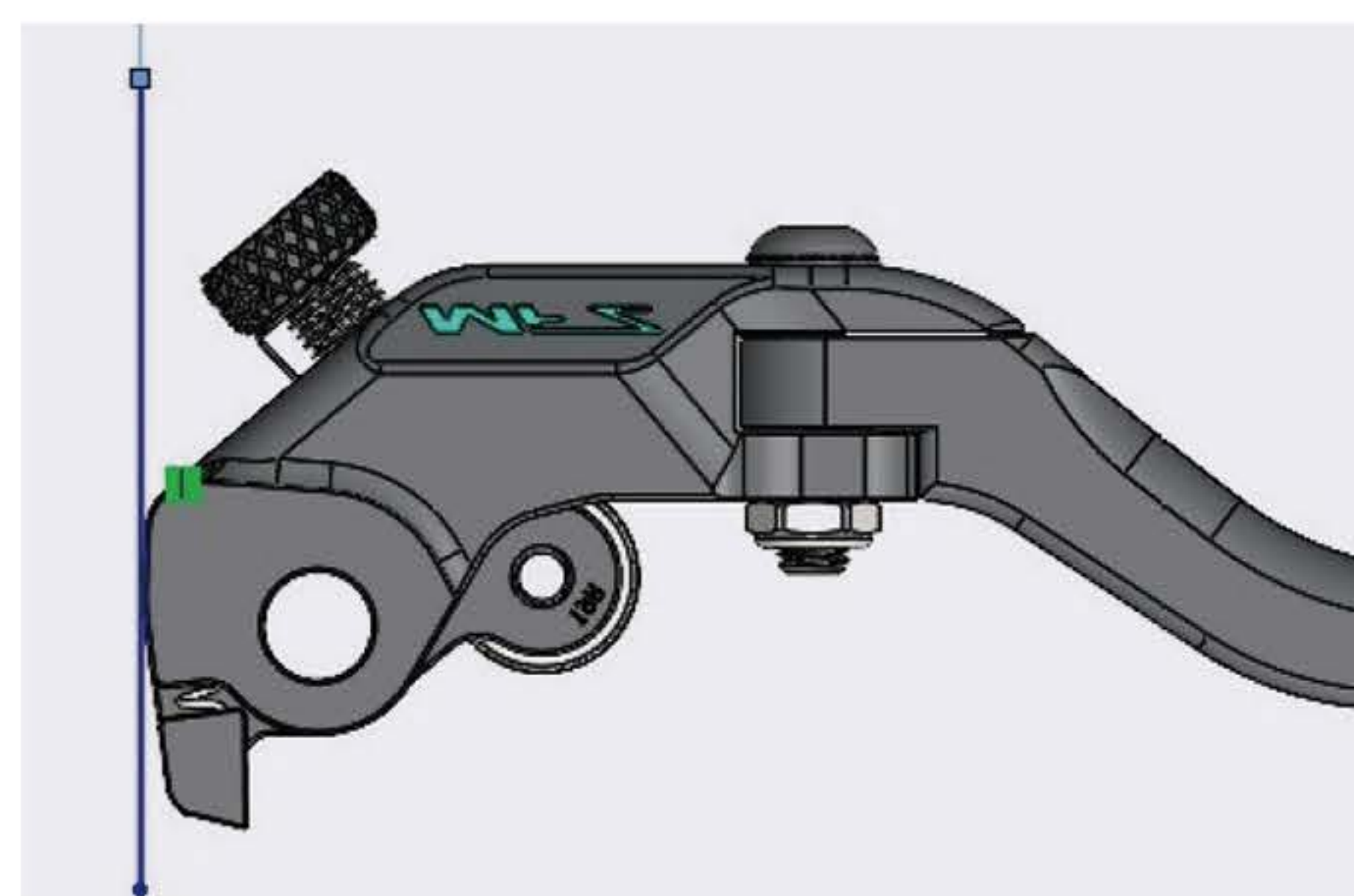

● 電子開關設計/Microswitch design

開關採用電子感應設計了,反應更加靈敏

The switch adopts an electronic induction design, with more sensitive response.



● 拉桿行程可調/Adjustable lever stroke.

拉桿行程可旋鈕調整依手握習慣調整距離提升煞車手感

The lever stroke is knob-adjustable, allowing distance adjustment according to hand grip habits for improved braking feel.



摩法斯總泵系列

Split Master Cylinder

● 核心設計解析 / Core Design Analysis

旋轉行程旋鈕可改變剎車拉桿自由行程：調短則剎車響應更靈敏，輕捏即生效，適合賽道等需快速制動場景；調長則需捏動更大幅度才起作用，剎車力度更線性柔和，適合城市道路等需頻繁輕剎車場景。

Rotating the stroke knob adjusts the brake lever's free travel: shorter for quicker response (light squeeze works), ideal for fast braking (e.g., tracks); longer needs more squeeze, with smoother force—suited for frequent light braking (e.g., city roads).

● 聚焦改裝與實用價值 / Product feature function



變距滾輪設計讓車手更精準地感知制動介入的輕重，提升操控舒適性

Variable-pitch roller design lets riders precisely feel brake intensity, boosting control comfort.



採用折疊式拉桿設計，可減輕摔倒時主缸所受損傷

Foldable lever design reduces master cylinder damage in case of falls.



通過行程旋鈕調整手拉桿距離，可匹配不同車手的手指長度及握力習慣

Adjust lever distance via the stroke knob to fit riders' finger lengths and grip habits.

● 可更換拱桿塊 / Replaceable arch block

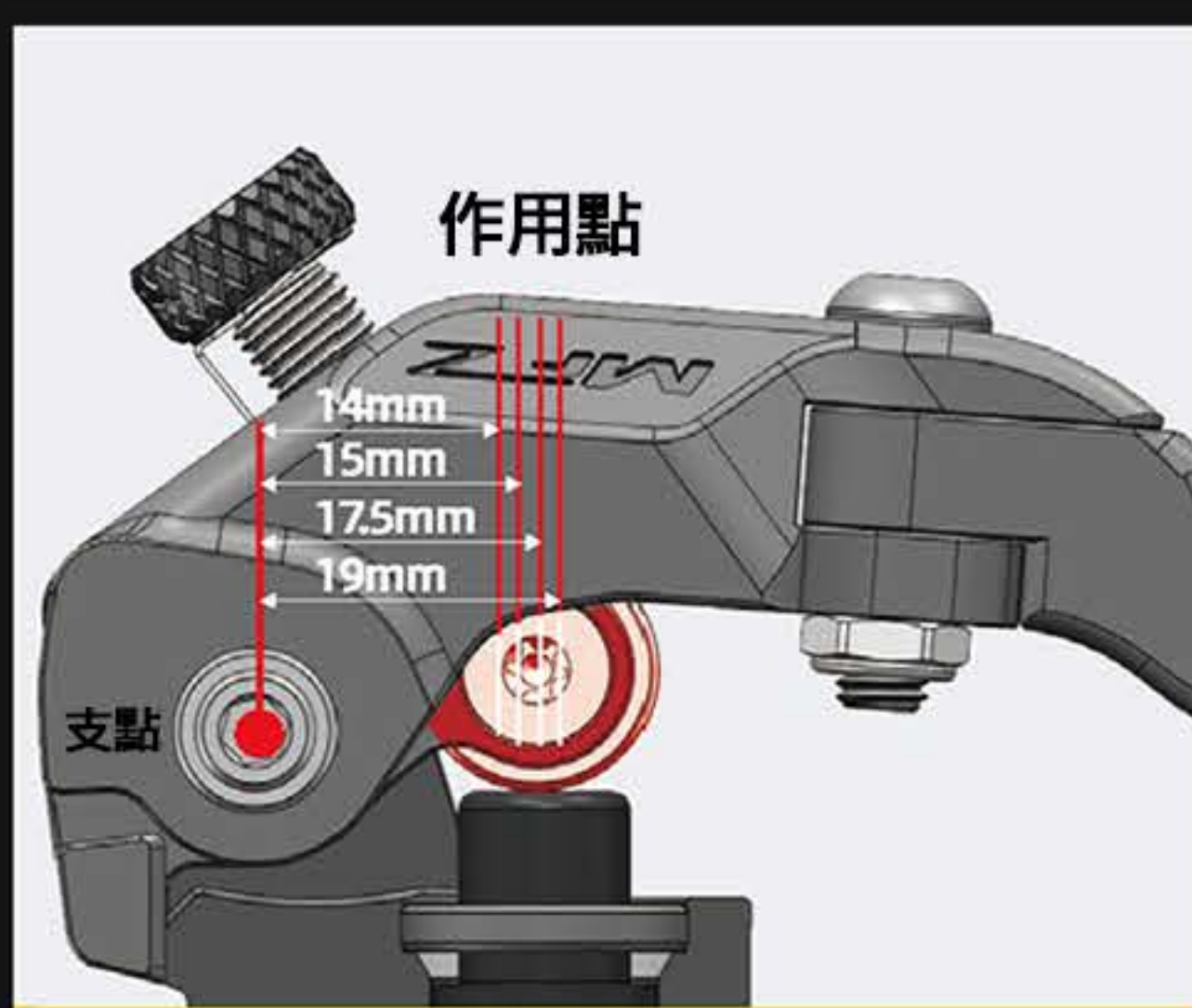

拱桿作用力示意圖
Force Diagram of Arch Bar



可調整拱桿比率14-20mm

更換拱桿塊,可改變拱桿比
Arch bar block replacement alters its ratio

14-20MM 拱桿比率調整範圍

Adjustment range: 14-20mm

手拉桿距離 Hand lever distance	力臂距 Arch bar distance	拱桿比 Arch bar ratio
140MM	14MM	10
	15MM	9.33
	16MM	8.75
	17MM	8.23
	18MM	7.77
	19MM	7.36
	20MM	7

● 手拉桿標準配備 (僅限方向盤側)

Power lever standard (steering wheel side only)

手拉桿為標準裝備，長度有一體款和折疊款兩種可供選擇

※ 離合器側採用標準形狀的直桿

The power rod comes as standard equipment, with two length options: standard and extended.

※ The clutch side adopts standard shape straight rod



折疊款 / Foldable version



一體款 / Integrated version

01款: 分離式總泵系列

01R/S Master Pump

依據車輛車型與煞車系統差異,摩法斯系列提供豐富規格及車型的總泵,輔助騎士升級煞車體驗。更換總泵後,煞車手感更線性、反應更靈敏,制動力控制也更精準。

According to differences in vehicle models and brake systems, the Mofas series offers master cylinders in abundant specifications and models, helping riders upgrade their braking experience. After replacing the master cylinder, the braking feel is more linear, the response is more sensitive, and the braking force control is more precise.

01款分離總泵主體 / 01 split master cylinder main body



產品配件清單 / List of Product Accessories



支援多車型主缸適配, 兼容街車 / 仿賽 / adv, 改車無需換總成

Supports master cylinder adaptation for multiple models, compatible with street bikes, sportbikes and ADV. No need to replace the entire assembly when modifying the vehicle.

01R: 分離總泵摺疊手拉桿款 / Folding Version

活塞直徑Φ Piston Diameter	力臂距 Lever pitch	方向 Direction	手拉桿 Hand lever	圖號 Figure Number	適配車型 Compatible	備註 Remark
Φ17.5	19MM	左L	標/Std	/	通用 Universal	可更換槓桿塊 以改變槓桿距 Replaceable arch bar blocks to adjust the arch bar distance
		右R	長/Ext	10101064-00-00		
Φ15	19MM	左L	標/Std	10101051-00-00		
		右R	長/Ext	10101051-00-01		
Φ14	19MM	左L	標/Std	10101074-00-00		
		右R	長/Ext	/		
Φ15	19MM	左L	標/Std	10101065-00-00		
		右R	長/Ext	10101065-00-01		
Φ14	19MM	左L	標/Std	10101073-00-00		
		右R	長/Ext	10101073-00-01		

01S: 分離總泵一體手拉桿款 / Integrated Version

活塞直徑Φ Piston Diameter	力臂距 Lever pitch	方向 Direction	手拉桿 Hand lever	圖號 Figure Number	適配車型 Compatible	備註 Remark
Φ19	19MM	左L	標/Std	10101060	通用 Universal	可更換槓桿塊 以改變槓桿距 Replaceable arch bar blocks to adjust the arch bar distance
		右R	標/Std	10101061		
Φ17.5	19MM	左L	標/Std	10101058		
		右R	標/Std	10101057		
Φ15	19MM	左L	標/Std	10101059		
		右R	標/Std	10101001		
Φ14	19MM	左L	標/Std	10101056		
		右R	標/Std	10101052		



03款: 分離總泵系列

03R Master Pump

03款分離總泵主體

03 split master cylinder main body

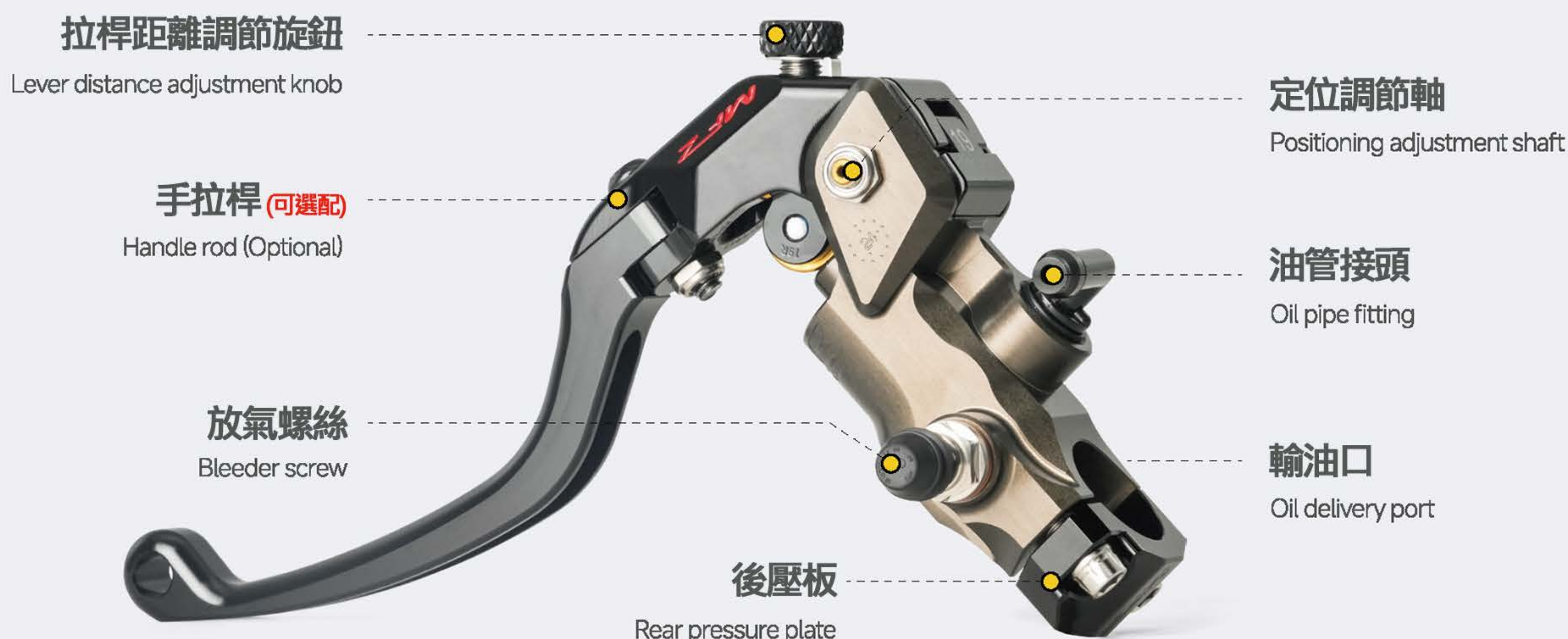

產品配件清單

Accessories List

墊片
Gasket



電子開關
Microswitch



支架
Bracket



油杯
Oil reservoir



裝配圖

Assembly Drawing



支援多車型主缸適配, 兼容街車 / 仿賽 / adv, 改車無需換總成

Supports master cylinder adaptation for multiple models, compatible with street bikes, sportbikes and ADV. No need to replace the entire assembly when modifying the vehicle.

03R: 分離總泵折疊手拉桿款 / Folding Version

活塞直徑Φ Piston Diameter	力臂距 Lever pitch	方向 Direction	手拉桿 Hand lever	圖號 Figure Number	適配車型 Compatible	備註 Remark
Φ19	19MM	左L	標/Std	10101039-00-00	通用 Universal	可更換槓桿塊 以改變槓桿距 Replaceable arch bar blocks to adjust the arch bar distance
			長/Ext	10101039-00-01		
			標/Std	10101037-00-00		
		右R	標/Std	10101037-00-03		
			長/Ext	10101037-00-01		
			長/Ext	10101037-00-02		
Φ17.5	19MM	左L	標/Std	10101028-00-00		
			長/Ext	10101028-00-01		
		右R	標/Std	10101026-00-00		
			長/Ext	10101026-00-01		
		左L	標/Std	10101021-00-00		
			長/Ext	10101021-00-01		
Φ15	19MM	右R	標/Std	10101030-00-00		
			長/Ext	10101030-00-01		



摩托車
MFZ-Sport



競賽賽事
Competitive events



安裝工具
Replacement tool



安裝設備
Install equipment



性能強勁
Strong performance



耐磨性高
Wear resistance



耐腐蝕性
Corrosion-resistant

05款: 分離總泵系列

05S Master Pump

● 05款分離總泵主體

05 split master cylinder main body

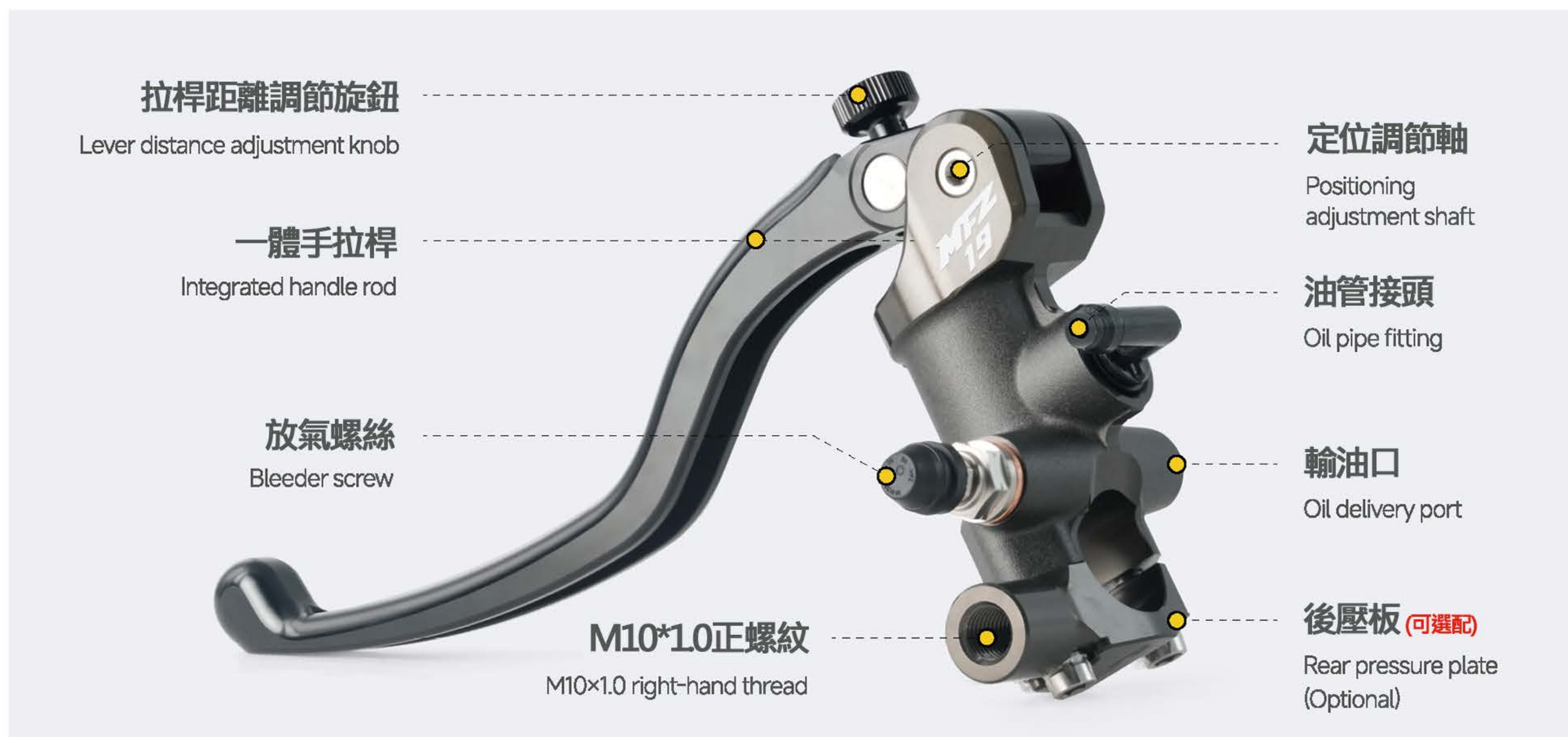

產品配件清單

Accessories List

墊片
Gasket壓力開關
Pressure switch油管
Oil pipe油杯
Oil reservoir

裝配圖

Assembly Drawing



支援多車型主缸適配, 兼容街車 / 仿賽 / adv, 改車無需換總成

Supports master cylinder adaptation for multiple models, compatible with street bikes, sportbikes and ADV. No need to replace the entire assembly when modifying the vehicle.

05S: 分體總泵一體手拉桿款 / Integrated Version

活塞直徑Φ Piston Diameter	力臂距 Lever pitch	方向 Direction	手拉桿 Hand lever	圖號 Figure Number	適配車型 Compatible	備註 Remark
Φ19	19MM	左L	標/Std	10101062	通用 Universal	可更換槓桿塊 以改變槓桿距 Replaceable arch bar blocks to adjust the arch bar distance
		右R	標/Std	10101018		
Φ17.5	19MM	左L	標/Std	10101063		
		右R	標/Std	10101043		
Φ15	19MM	左L	標/Std	10101044		
		右R	標/Std	10101017		
Φ14	19MM	左L	標/Std	/		
		右R	標/Std	10101050		



摩法斯總泵系列

Split Master Cylinder

一體式鍛造總泵

INTEGRATED FORGED MASTER CYLINDER



嚴選航空級鋁合金打造,泵體經鍛造工藝一體成型,兼顧輕量化與高強度,堅固耐用,輕鬆應對複雜騎行場景。細節設計更藏巧思:強化密封油杯,有效杜絕漏油隱患,穩定油壓輸出;人體工學拉桿貼合手部曲線,久握不累,操控行雲流水;拉桿調節旋鈕靈活易用,可精準適配不同騎行習慣;搭配不銹鋼螺絲固件,防腐防銹,保障長期可靠性能。

Made from premium aerospace aluminum, the pump body is forged as one, balancing light weight and high strength—sturdy enough for tough rides. Smart details: Reinforced sealed oil reservoir stops leaks, stabilizes pressure; ergonomic pull rod fits hands, stays comfortable for easy control; adjustable knob suits different riding habits; stainless steel screws resist corrosion for long-term reliability.



一體式油杯

Forged aluminium alloy



電子開關設計

Microswitch design



行程距離可調節

Adjustable stroke distance

輪殼
Wheel

卡鉗
Callipers

上泵
Master Pump

減震
Shock absorption

配件
Attachment



摩托車
MFZ-Spart



競賽賽事
Competitive events



安裝工具
Replacement tool



安裝設備
Install equipment



性能強勁
Strong performance



耐磨性高
Wear resistance



耐腐蝕性
Corrosion-resistant

02款：一體總泵系列

02R Master Pump

一體式總泵主體

Integrated master cylinder body

拉桿距離調節旋鈕
Lever distance adjustment knob

手拉桿 (可選配)
Handle rod (Optional)

一體式油杯
Integrated oil reservoir

定位調節軸
Positioning adjustment shaft

輸油口
Oil delivery port

後壓板
Rear pressure plate

產品配件清單

List of Product Accessories

電子開關
Microswitch



墊片
Gasket



支援多車型主缸適配, 兼容街車 / 仿賽 / adv, 改車無需換總成

Supports master cylinder adaptation for multiple models, compatible with street bikes, sportbikes and ADV. No need to replace the entire assembly when modifying the vehicle.

02R: 一體總泵折疊款 / Folding Version

活塞直徑Φ Piston Diameter	力臂距 Lever pitch	方向 Direction	手拉桿 Hand lever	圖號 Figure Number	適配車型 Compatible	備註 Remark
Φ19	15MM	左L	標/Std	10101035-00-00	通用 Universal	可更換槓桿塊 以改變槓桿距 Replaceable arch bar blocks to adjust the arch bar distance
		左L	長/Ext	10101035-00-01		
		右R	標/Std	10101033-00-00		
		右R	長/Ext	10101033-00-01		
Φ17.5	15MM	左L	標/Std	10101048-00-00		
		左L	長/Ext	10101048-00-01		
		右R	標/Std	10101022-00-00		
		右R	標/Std	10101022-00-02		
			長/Ext	10101022-00-01		
Φ15	15MM	左L	標/Std	10101046-00-00		
		左L	長/Ext	10101046-00-01		
		右R	標/Std	/		
		右R	長/Ext	10101024-00-01		
Φ14	15MM	左L	長/Ext	10101070-00-00		
Φ13.5	左L15/右R16MM	左L	標/Std	10101042-00-00		
		右R	標/Std	10101041-00-00		



省力離合/配件展示

Clutch / Accessories Display

● 省力離合總成 / Easy - pull Clutch Assembly

摩托車鋁合金煞車離合拉桿,拉桿行程可旋鈕調整,牛角的角度也隨著變化,根據手掌的大小自由調節,讓騎行更輕鬆,圓弧拋光工藝,轉折更自然,折疊設計碰撞時有效防止牛角彎曲和斷裂。

Motorcycle aluminum alloy brake and clutch levers feature a knob-adjustable stroke, with the angle of the levers changing accordingly. They can be freely adjusted based on palm size for more comfortable riding. The arc polishing process ensures smoother transitions, while the foldable design effectively prevents the levers from bending or breaking in case of impact.

04R左折疊離合器總成

04R Left - folding Clutch Assembly

圖號:10101014

drawing number



裝車實拍

Live Shots of Loading onto Vehicle



行程微調功能

Live Shots of Loading onto Vehicle



滿足各種大小手掌的需求旋鈕調節
Knob adjustment to meet the needs of palms of various sizes

輪轂
Wheel

卡鉗
Callipers

上泵
Master Pump

減震
Shock absorption

配件
Attachment

省力離合/配件展示

Clutch / Accessories Display

調節線配件 / Adjustment cable accessories

傳統剎車拉桿調節需工具靠近煞車泵操作，而遠程調節線將調節點延伸至車把等易操作區域，可隨時徒手調整，尤其適合騎行中臨時優化剎車手感快速適應車輛制動特性。

Traditional brake lever adjustment requires tools near the brake pump, while the remote adjustment cable extends the adjustment point to easily accessible areas like the handlebars, allowing for tool-free adjustments at any time—ideal for quickly optimizing brake feel during rides to adapt to vehicle braking characteristics.

產品配件清單

Accessories List

壓線塊*2
Cable clamp *2



壓線鎖頭*1
Cable locking head *1



剎車拉桿遠程調節線

Brake lever remote adjustment cable

MFZ-10106022-00-00



剎車拉桿遠程調節線(固定線款)

Brake lever remote adjustment cable (fixed cable version)

MFZ-10106024-00-00



適配原廠車手拉桿

Fits original factory hand lever

● 右橫向調節拉桿 / Easy - pull Clutch Assembly



實現剎車或離合的個性化調節

Stainless steel positioning adjustment shaft

右橫向調節拉桿適配01/02/03款上泵，右橫向調節拉桿能夠改變拉桿的槓桿比，進而調整操作時所需的力度

The right lateral adjustment rod is compatible with the 01/02/03 model master cylinders. It can flexibly change the lever ratio of the pull rod, thereby adjusting the force required during operation.

● 適配R3/CBR250原車上泵 / Fits original master cylinders of R3 and CBR250



R3右原廠車上泵 Right - hand original factory master cylinder for R3

專為雅瑪哈R3量身訂製的原廠上泵，無須複雜調試，裝車即與剎車管路，卡鉗精準咬合，復刻原車班制動手感

The original master cylinder, tailor-made for the Yamaha R3, requires no complex adjustments. Once installed, it seamlessly engages with the brake lines and calipers, replicating the original braking feel of the vehicle.



CBR250右原廠車上泵 CBR250 left original master cylinder

專為CBR250原車設計，與車輛制動系統完美匹配，無須額外適配調試，裝車即享如初的制動響應

Designed specifically for the original CBR250, it perfectly matches the vehicle's braking system. No additional adaptation or debugging is required, and you'll enjoy the same braking response as the original once installed.



摩托車
MFZ-Spart



競賽賽事
Competitive events



安裝工具
Replacement tool



安裝設備
Install equipment



性能強勁
Strong performance



耐磨性高
Wear resistance



耐腐蝕性
Corrosion-resistant

輪轂
Wheel

卡鉗
Calipers

上泵
Master Pump

減震
Shock absorption

配件
Attachment



